

SSV KIT - Upper Soft Door Panels - Maverick X3 MAX (outside Europe)%2C Maverick MAX (Europe only)

Part number (SKU) : 715003753,715003755,715008092

Product: **Side-by-side**
 Project no: **487802300_rev4**
 Instruction Sheet P/N: **487802300**
 Revision no: **4**
 Revision date: **December, 2020**
 Item covered: **Upper Soft Door Panels - Maverick X3 MAX (outside Europe) / Maverick MAX (Europe only)**

The following symbols may be used in this document:

WARNING

Indicates a hazardous situation which, if not avoided, could result in death or serious injury.

⚠ CAUTION: Indicates a hazard situation which, if not avoided, could result in minor or moderate injury.

NOTICE Indicates an instruction which, if not followed, could severely damage vehicle components or other property.

WARNING

- This kit is designed for specific applicable models only (authorized BRP dealers will confirm model(s)). It is not recommended for units other than the one (those) for which it was sold.
- If the installation of the kit requires a template, ensure template is to scale.
- Should removal of a locking device (e.g. lock tabs, self-locking fasteners, etc.) be required when undergoing disassembly/assembly, always replace with a new one.
- Torque wrench tightening specifications must strictly be adhered to.

WARNING

Some important safety information and/or operating instructions dedicated to the end user might be included in this instruction sheet. Make sure to give the kit part number as well as the instruction sheet included with this kit to the customer. Verify that the customer has access to all the information required for proper use of the accessory.

NOTE: USE TIGHTENING TORQUES IN THE FOLLOWING TABLE IF NOT OTHERWISE SPECIFIED.

	GRADE			
	5.8	8.8	10.9	12.9

M4	1.8 ± 0.2 N•m (16 ± 2 lbf•in)	2.8 ± 0.2 N•m (25 ± 2 lbf•in)	3.8 ± 0.2 N•m (34 ± 2 lbf•in)	4.5 ± 0.5 N•m (40 ± 4 lbf•in)
M5	3.3 ± 0.2 N•m (29 ± 2 lbf•in)	5 ± 0.5 N•m (44 ± 4 lbf•in)	7.8 ± 0.7 N•m (69 ± 6 lbf•in)	9 ± 1 N•m (80 ± 9 lbf•in)
M6	7.5 ± 1 N•m (66 ± 9 lbf•in)	10 ± 2 N•m (89 ± 18 lbf•in)	12.8 ± 2.2 N•m (113 ± 19 lbf•in)	16 ± 2 N•m (142 ± 18 lbf•in)
M8	15.3 ± 1.7 N•m (135 ± 15 lbf•in)	24.5 ± 3.5 N•m (18 ± 3 lbf•ft)	31.5 ± 3.5 N•m (23 ± 3 lbf•ft)	40 ± 5 N•m (30 ± 4 lbf•ft)
M10	29 ± 3 N•m (21 ± 2 lbf•ft)	48 ± 6 N•m (35 ± 4 lbf•ft)	61 ± 9 N•m (45 ± 7 lbf•ft)	73 ± 7 N•m (54 ± 5 lbf•ft)
M12	52 ± 6 N•m (38 ± 4 lbf•ft)	85 ± 10 N•m (63 ± 7 lbf•ft)	105 ± 15 N•m (77 ± 11 lbf•ft)	128 ± 17 N•m (94 ± 13 lbf•ft)
M14	85 ± 10 N•m (63 ± 7 lbf•ft)	135 ± 15 N•m (100 ± 11 lbf•ft)	170 ± 20 N•m (125 ± 15 lbf•ft)	200 ± 25 N•m (148 ± 18 lbf•ft)
M16	126 ± 14 N•m (93 ± 10 lbf•ft)	205 ± 25 N•m (151 ± 18 lbf•ft)	255 ± 30 N•m (188 ± 22 lbf•ft)	305 ± 35 N•m (225 ± 26 lbf•ft)
M18	170 ± 20 N•m (125 ± 15 lbf•ft)	273 ± 32 N•m (201 ± 24 lbf•ft)	330 ± 25 N•m (243 ± 18 lbf•ft)	413 ± 47 N•m (305 ± 35 lbf•ft)

NOTE: The illustrations in this document show typical construction of the different assemblies and may not reproduce the full detail or exact shape of the parts; however, they represent parts that have the same or similar function.

Installation time is approximately 1.0 hour.

USE AND CARE INFORMATION:

- Completely read and understand the instructions before installing this accessory.
- To clean, sponge with mild soap and cold water, rinse with a hose and allow it to drip-dry.
- Do not machine wash or dry.
- Use mild detergent to remove stubborn stains.
- When not in use, the window roll up webbing strap can be tucked into the velcro pocket.

The zipper should be cleaned using a toothbrush with soap and water and rinsed as needed to keep it free of dust and dirt. Once the zipper is cleaned, the teeth should be lubricated using beeswax.

WARNING

NEVER

- Put your elbow on the door while riding

NOTICE This accessory will create the need for more frequent air cleaner maintenance. Service the air cleaner daily when operating in dusty conditions.

PARTS TO BE INSTALLED

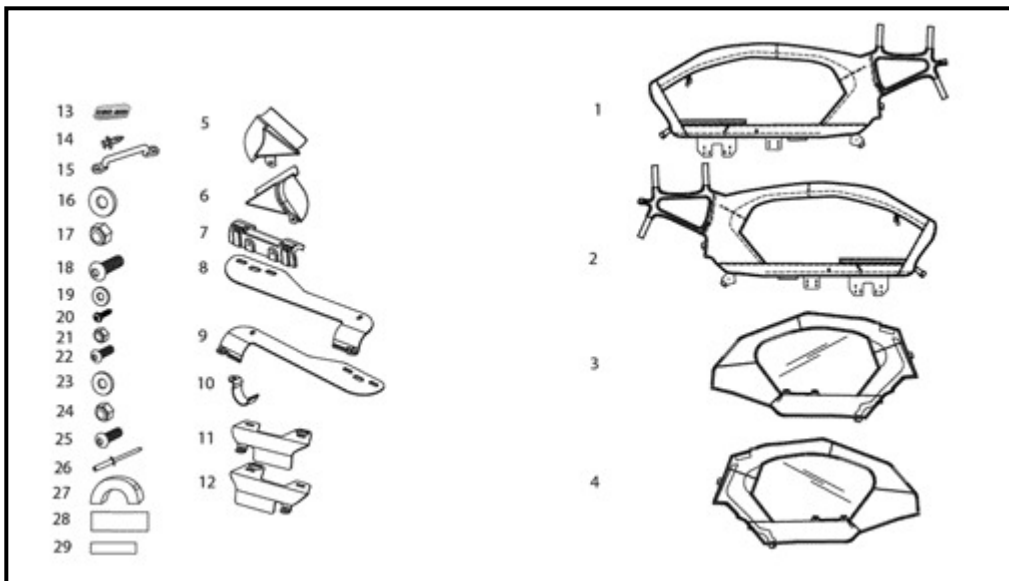

ITEM	DESCRIPTION	QTY
1	LHS Front door	1
2	RHS Front door	1
3	LHS Rear door	1
4	RHS Rear door	1
5	RHS Front triangle	1
6	LHS Front triangle	1
7	Bracket cover	2
8	LHS top front bracket	1
9	RHS top front bracket	1
10	C-clamp	2
11a	LHS top rear bracket (MY19 & Prior)	1
11b	LHS top rear bracket (MY20 & Up)	1
12a	RHS top rear bracket (MY19 & Prior)	1
12b	RHS top rear bracket (MY20 & Up)	1
13	Can Am decal	1
14	Rivet /Tuflok	2
15	Footman loop	2
16	M8 washer black	8
17	M8 lock nut	4
18	M8 Button head Torx screw	4

ITEM	DESCRIPTION	QTY
19	M5 washer black	10
20	#10 x .7 Torx self tapping screw	2
21	M5 lock nut black	4
22	M5 Torx button head screw	4
23	M6 washer black	30
24	M6 Lock nut black	10
25	M6 Torx Button head screw	34
26	3/16 rivet	2
27	1" Tube arch	12
28	2" x 4" self adhesive loop	2
29	1" x 3.5" self-adhesive loop	2

Service Parts

Item	description	qty
1	715005151	1
2	715005152	1

TOOLS REQUIRED:

- Gloves
- Safety goggles
- Torx driver (T30)
- Torx driver (T25)
- 10mm open end wrench
- 8mm open end wrench
- Rivet gun (optional)

INSTRUCTIONS

Installing the Doors

1. It is important to first choose the proper LHS & RHS top rear brackets [11a] or [11b] & [12a] or [12b] version needed for your vehicle.

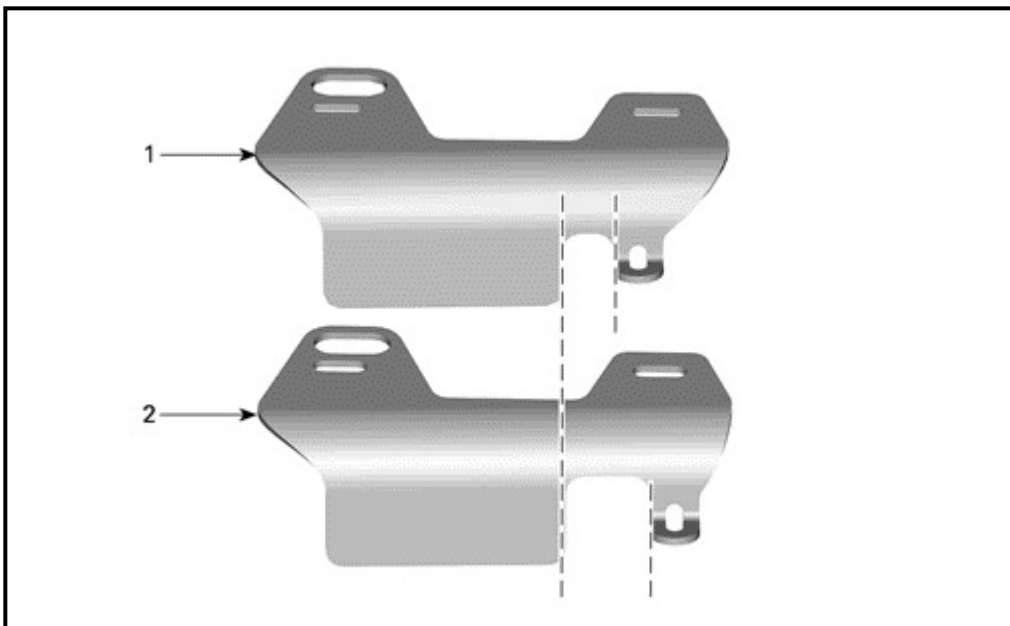

1. MY19 & Prior [11a][12a] with **NARROW** opening
2. MY20 & Up [P11b][12b] with **LARGE** opening

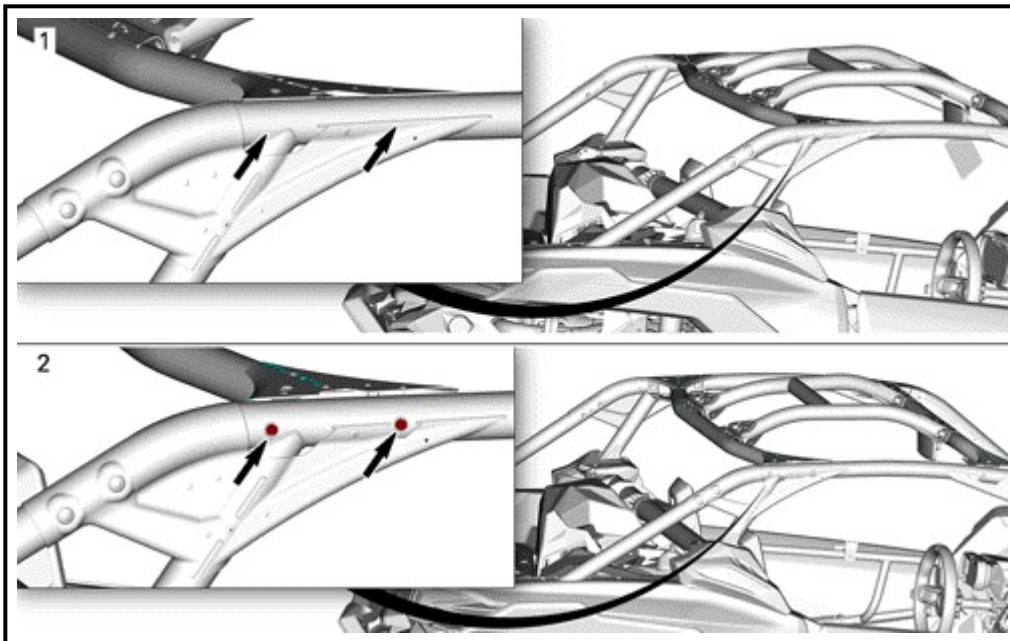

1. MY19 & Prior [11a][12a] cage **WITHOUT** knobs
2. MY20 & Up [P11b][12b] cage **WITH** knobs

2. Attach 1" x 3.5" self-adhesive strip [29] to the back of the top rear brackets: Clean flat section of LHS & RHS top rear brackets [11a] or [11b] & [12a] or [12b] with isopropyl alcohol. Remove protective backing on 1" x 3.5" self-adhesive loop [29] and apply to the back of the brackets.

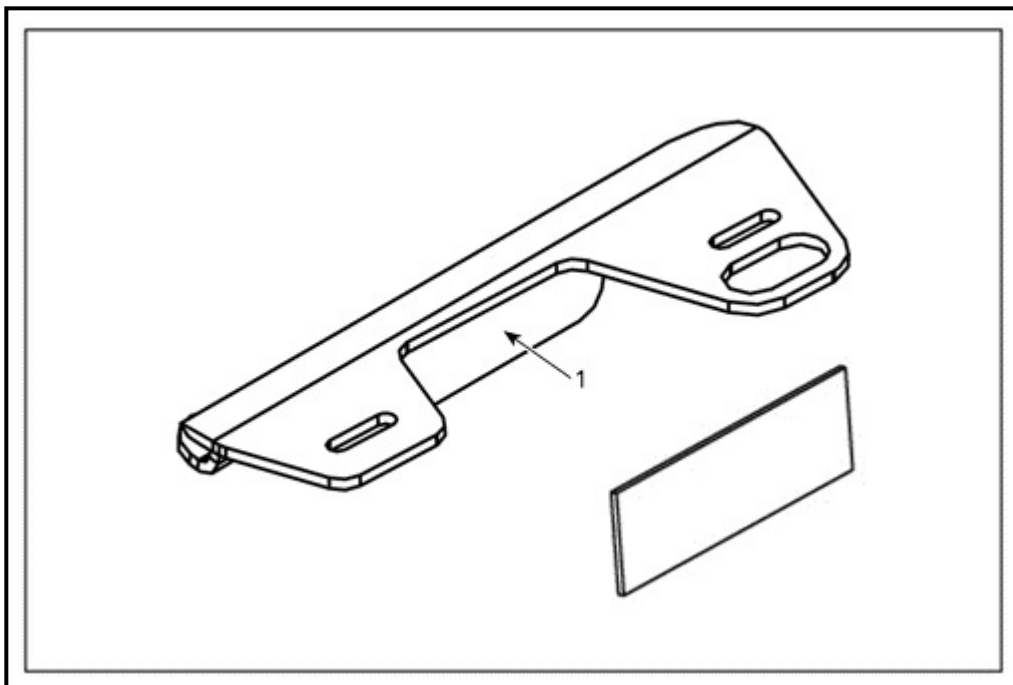

1. Back of the bracket

3. Assemble Top Rear Brackets to ROPS: Remove hard top and bolt down top brackets with M5 Torx button head screw [22], M5 washer [19] & M5 lock nut [21] at rear of LHS & RHS top rear brackets [11a] or [11b] & [12a] or [12b]. Reattach hard top and secure front of brackets with M5 Torx button head screw [22], M5 washer [19] & M5 lock nut [21] through hard top.

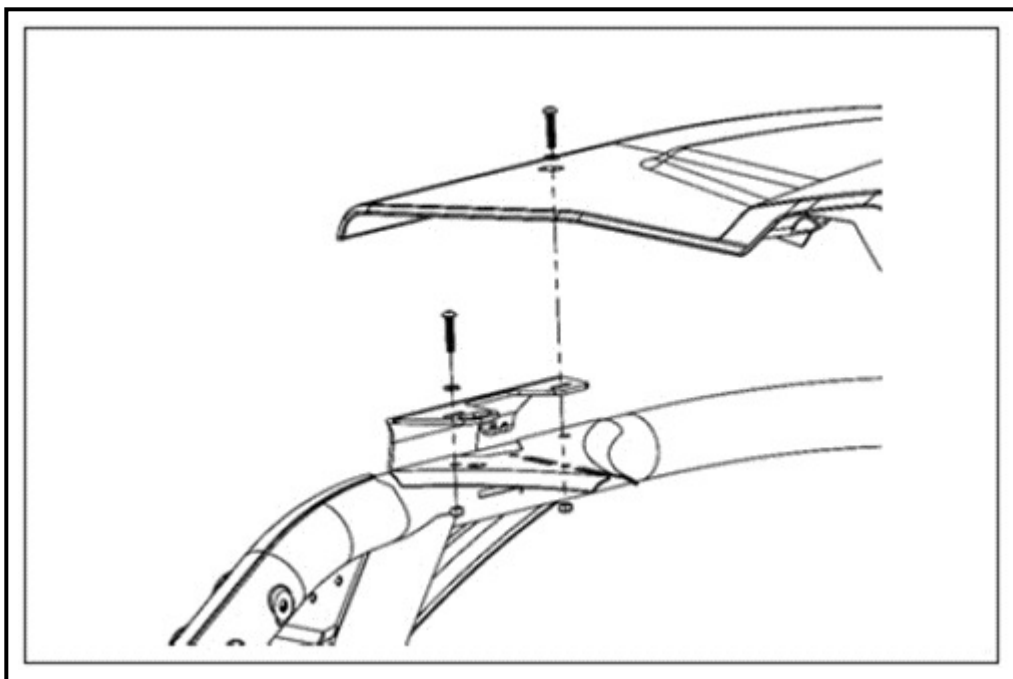

4. Assemble Top Rear Brackets [11a] or [11b] & [12a] or [12b], rivet option: Remove hard top and rivet down top brackets with 3/16 rivet [26] and M5 washer [19] at rear of LHS & RHS Top rear brackets [11a] or [11b] & [12a] or [12b]. Reattach hard top and secure front of brackets with M5 Torx button head screw [22], M5 washer [19] & M5 lock nut [21] through hard top.

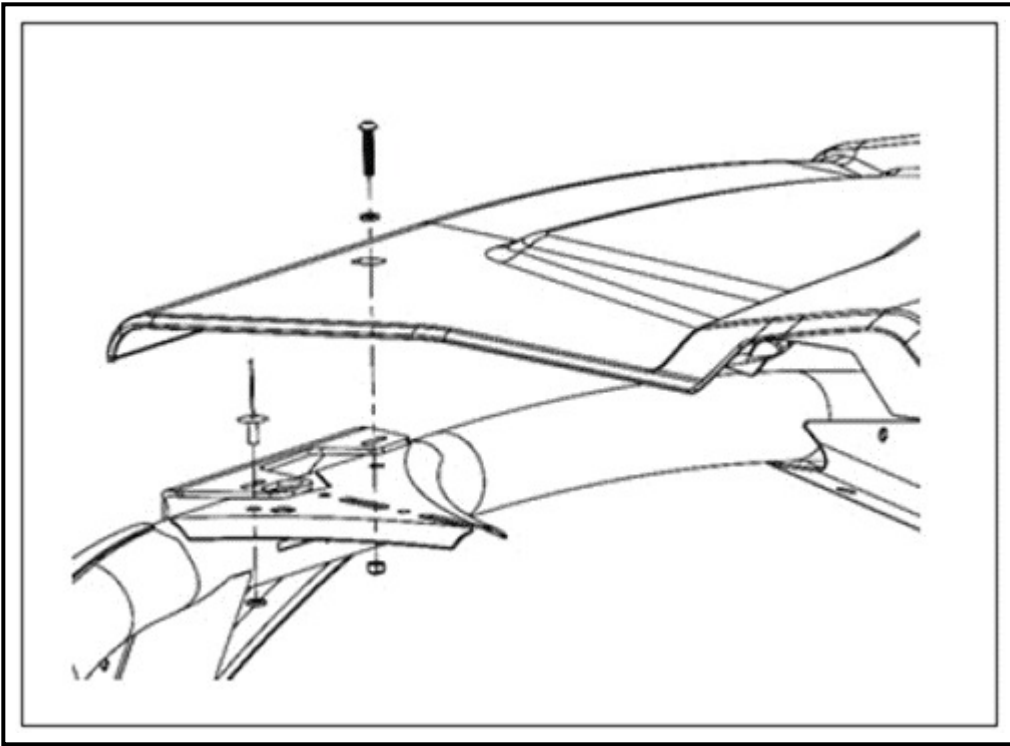

5. Assemble Top front brackets [8] & [9]: Remove hard top and bolt down Top front brackets with M8 Torx button head screw [18], M8 washer [16] & M8 lock nut [17].

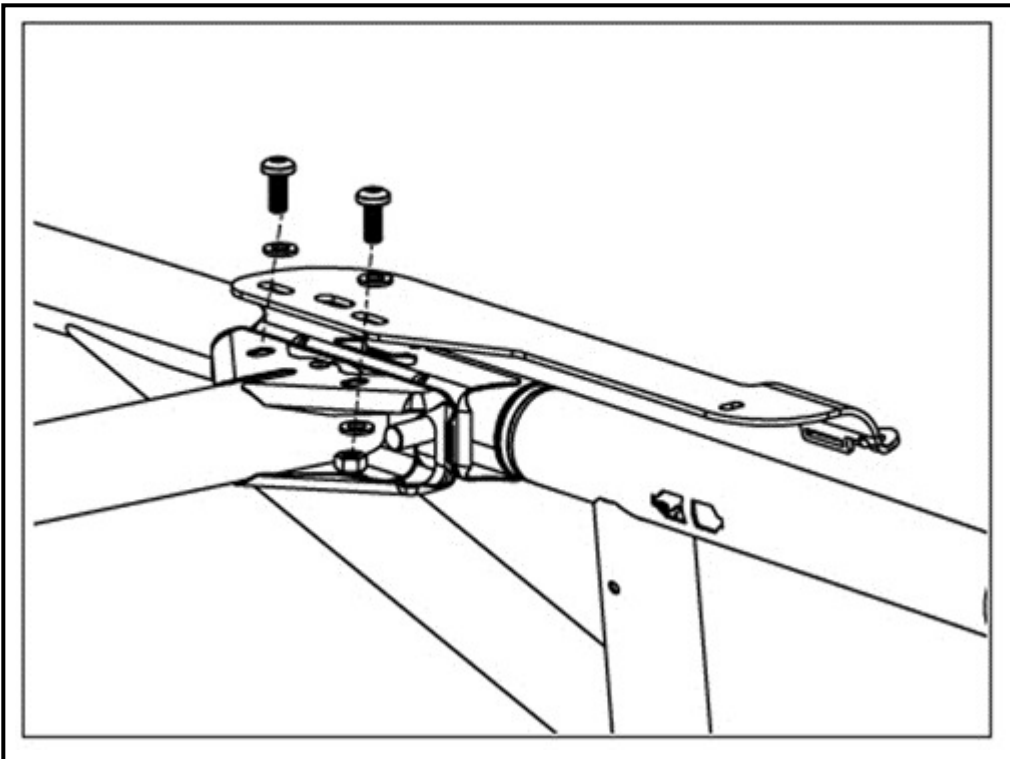

6. Attach C-clamp [10] to Top front brackets: Insert tab of C-clamp [10] into slot on Top front bracket, rotate to align slots on both parts. Insert M6 Torx button head screw [25] with M6 washers [23] & M6 lock nuts [24].

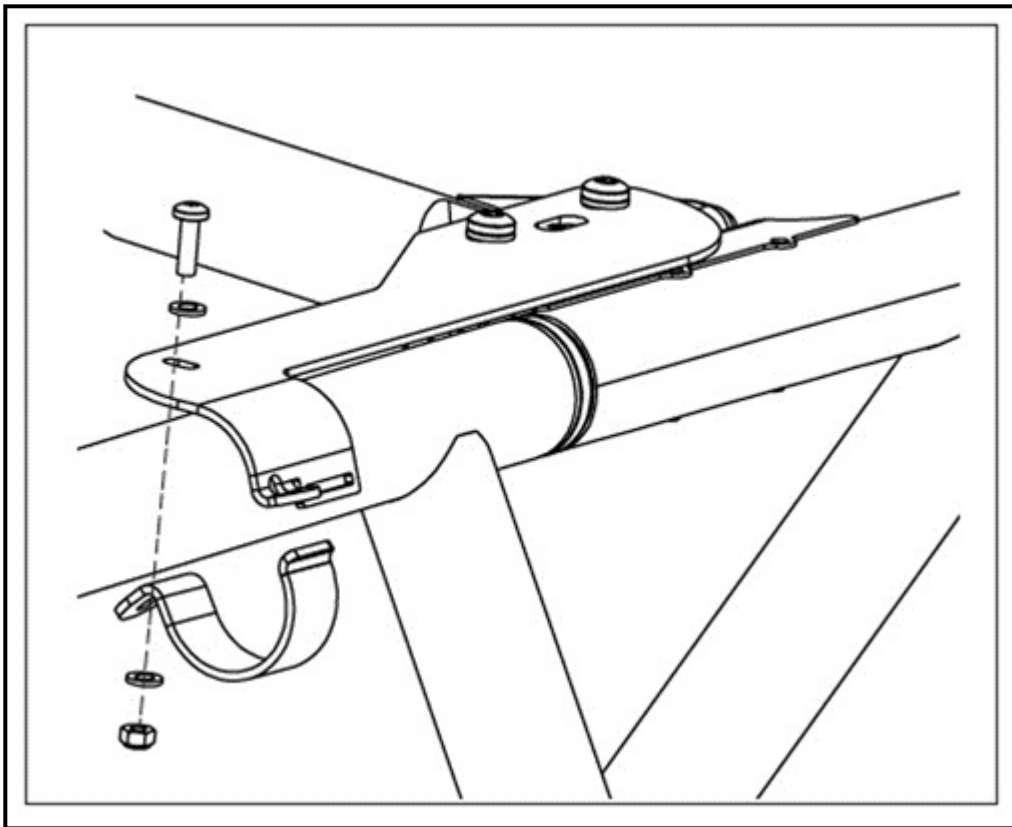

7. Attach RHS & LHS front triangles [5] & [6]: Snap rounded section of triangle around A pillar with tab inside of vehicle and secure with Rivet-Tuflok [14] on LHS & RHS.

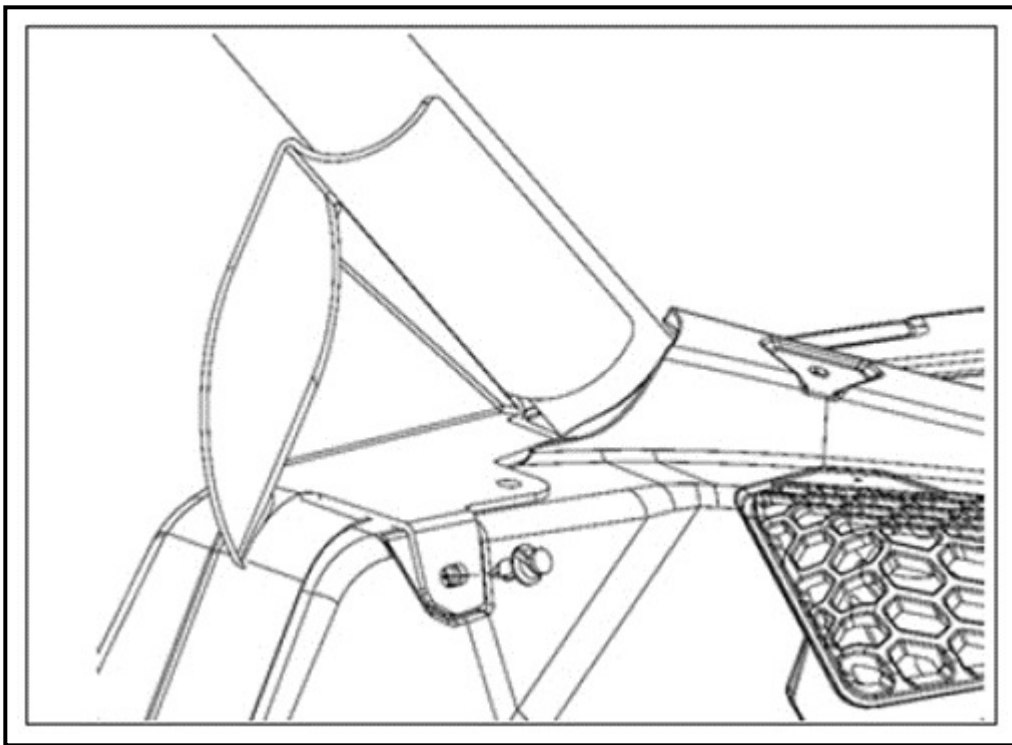

For Vehicles with glass windshield installed

8. Cut a part following the 715003752_template (same template for both sides). This cut is not required if a polycarbonate windshield is installed.

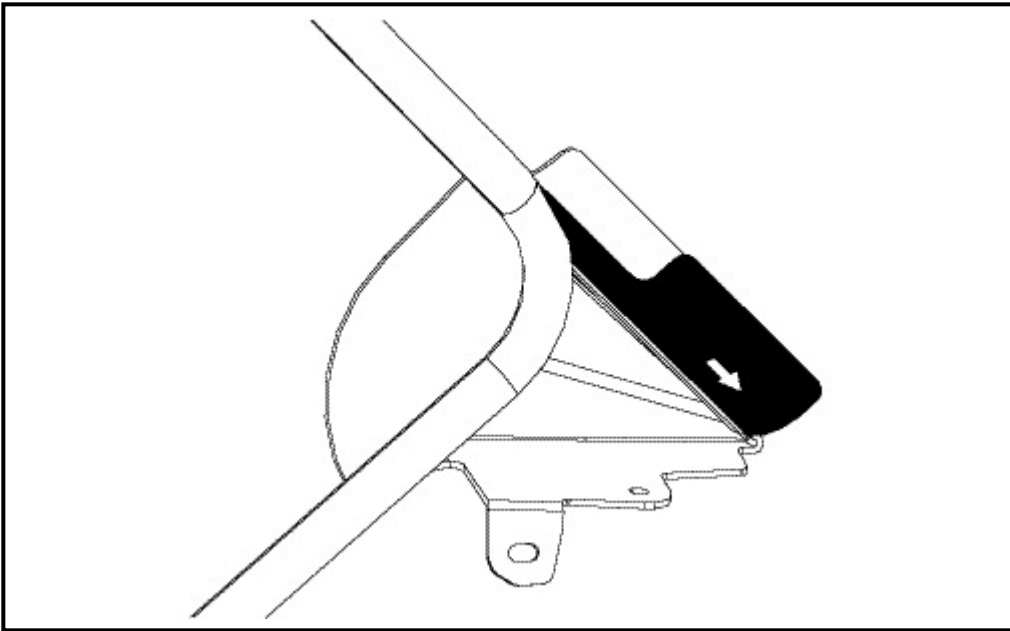

9. Attach 1" tube arches [27]: Snap arches on 1" front door frame and rotate to capture arch between 1" tube and outer door plastic. Repeat on opposite side.

NOTE: If vehicle is equipped with deluxe door handles (P/N 715004758), do not install the first front arch piece as it will be in interference with the handle support of the deluxe door handles (P/N 715004758).

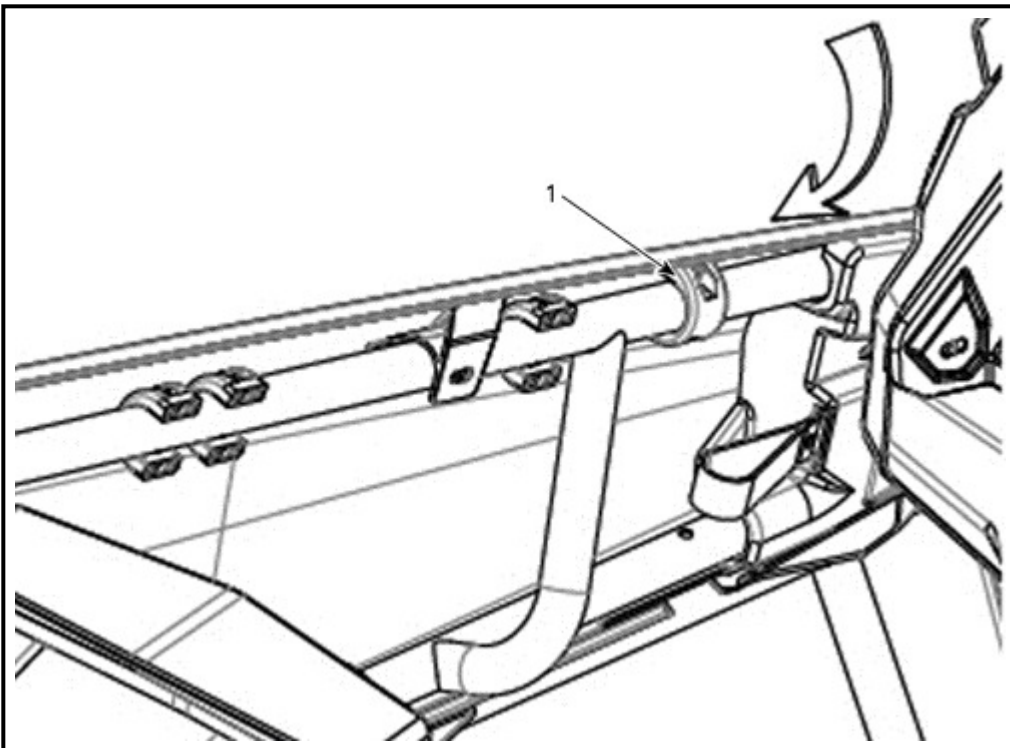

1. First arc piece

10. Attach doors to 1" tube arch [27] and adjust. Place door with brackets inside of vehicle (skin removed for clarity) Move arches to align with outer slots on door brackets. Attach to 1" arches with M6 washer [23] & M6 Torx button head screw [25]. Slide Footmans loop [15] under 1" tube and secure with M6 washer [23], M6 Torx button head screw [25] & M6 lock nut [24] to center slots on door brackets. Adjust the door camber so that the upper portion of the door contacts the ROP with 3-4

inches remaining before door closes. Once camber is adjusted correctly, the Footmans loop [15] can be adjusted in the slots so it is contacting the 1" tube and prevents the door from rotating.

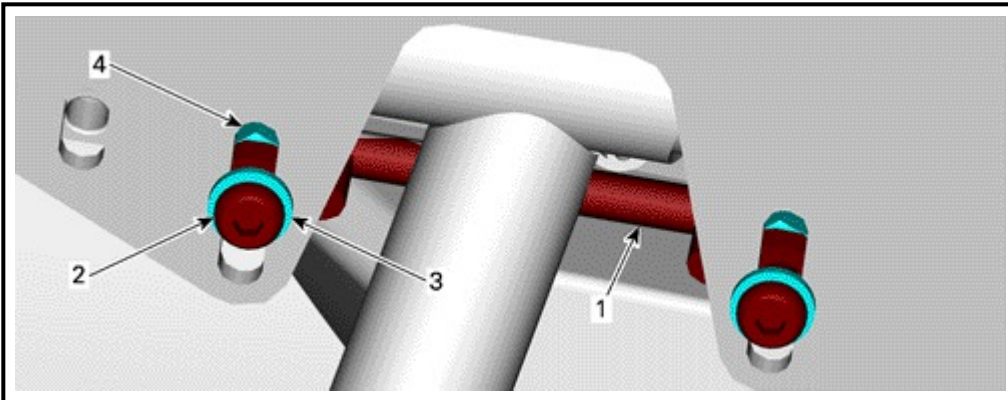
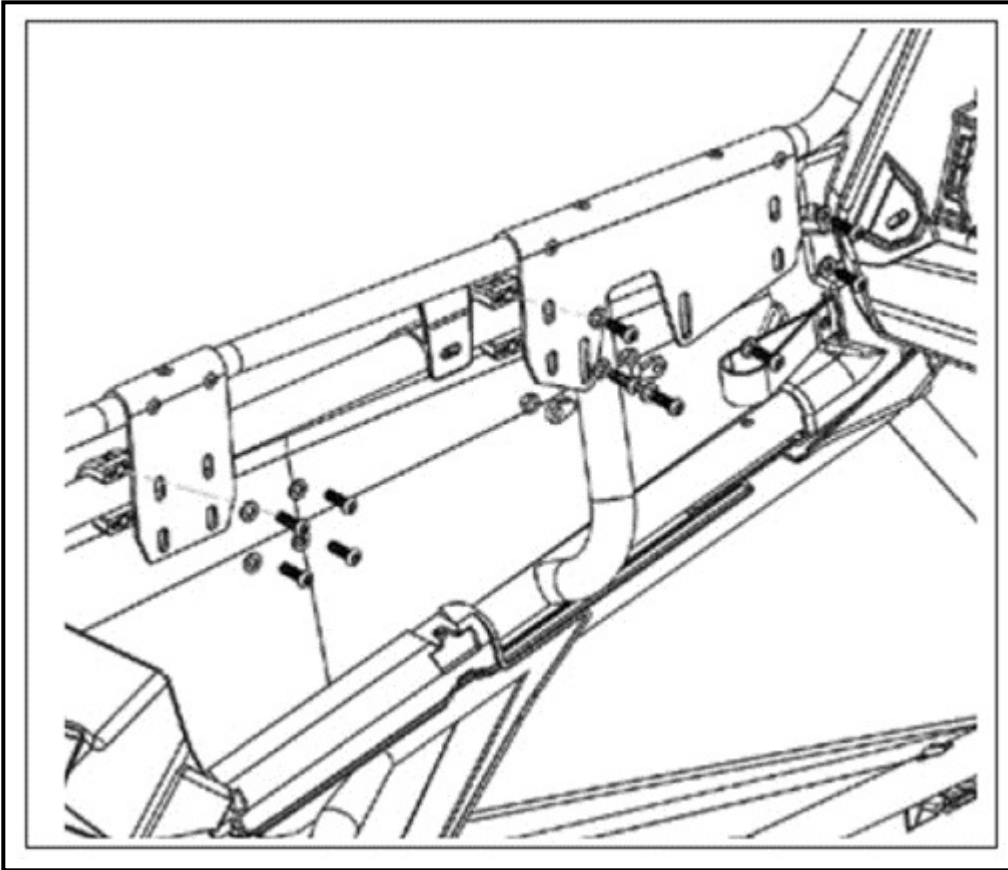

1. Footmans loop [15]
2. M6 Torx button head screw [25]
3. M6 washer [23]
4. M6 lock nut [24]

11. Attach hinge to Top front bracket [8] & [9]: Locate hinge to sit flat on bottom of Top Bracket, use M6 washer [23], M6Torx button head screw [25] & M6 lock nut [24] to secure to Top Bracket. (hardtop removed for clarity) Repeat for opposite side

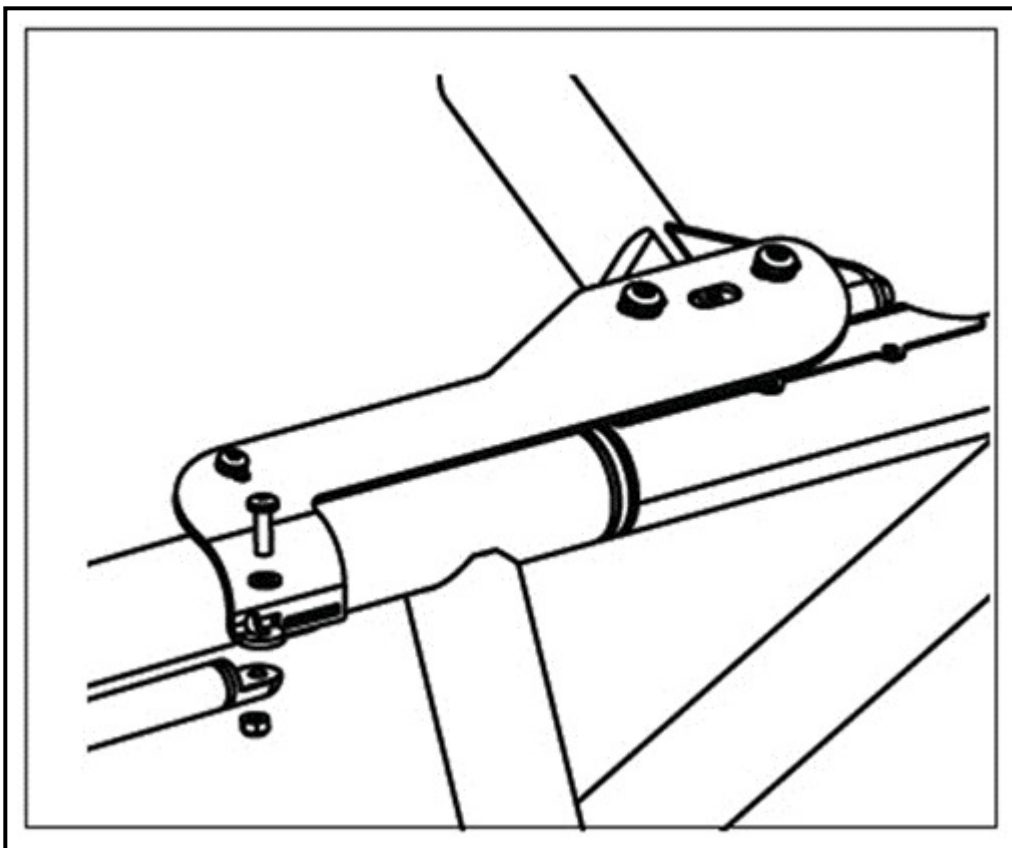

12. Secure front door skin to vehicle: Wrap hook / loop fasteners at bottom rear of door skin, around ROPS.

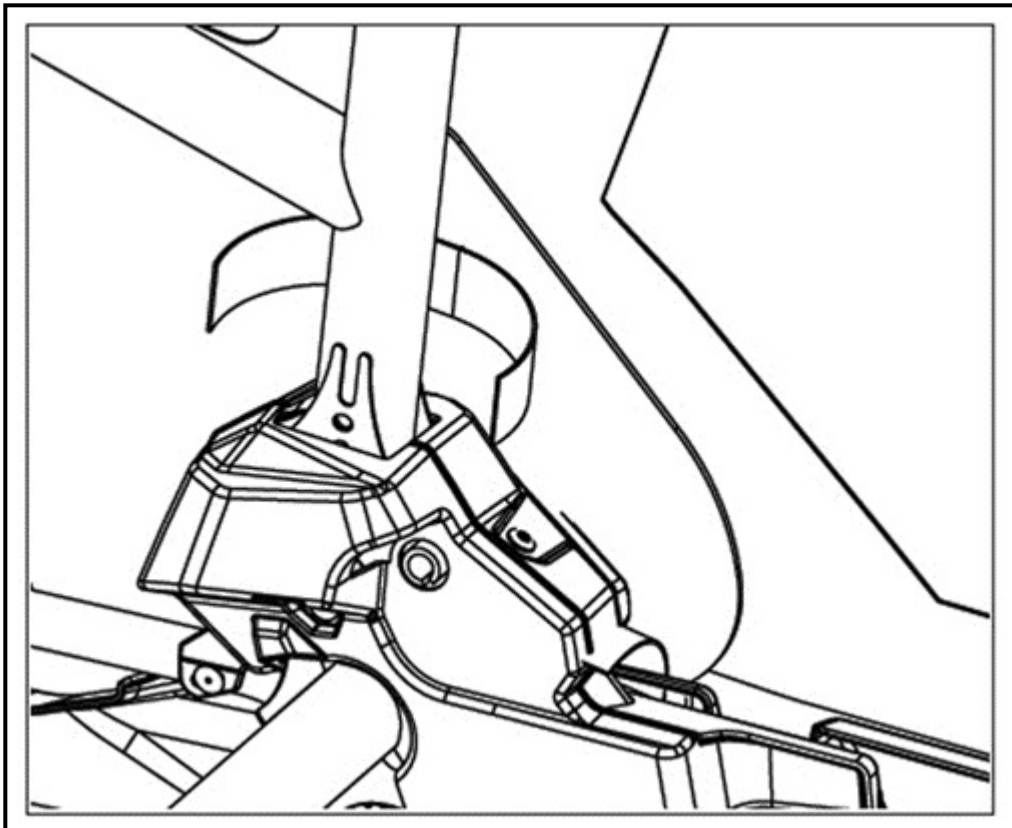

13. Remove 1" webbing with loop from ladder lock at rear of door skin and wrap around ROPS and back through loop in webbing. Thread through ladder lock and tighten to pull door skin. Wrap hook and loop closure round ROPS to secure.

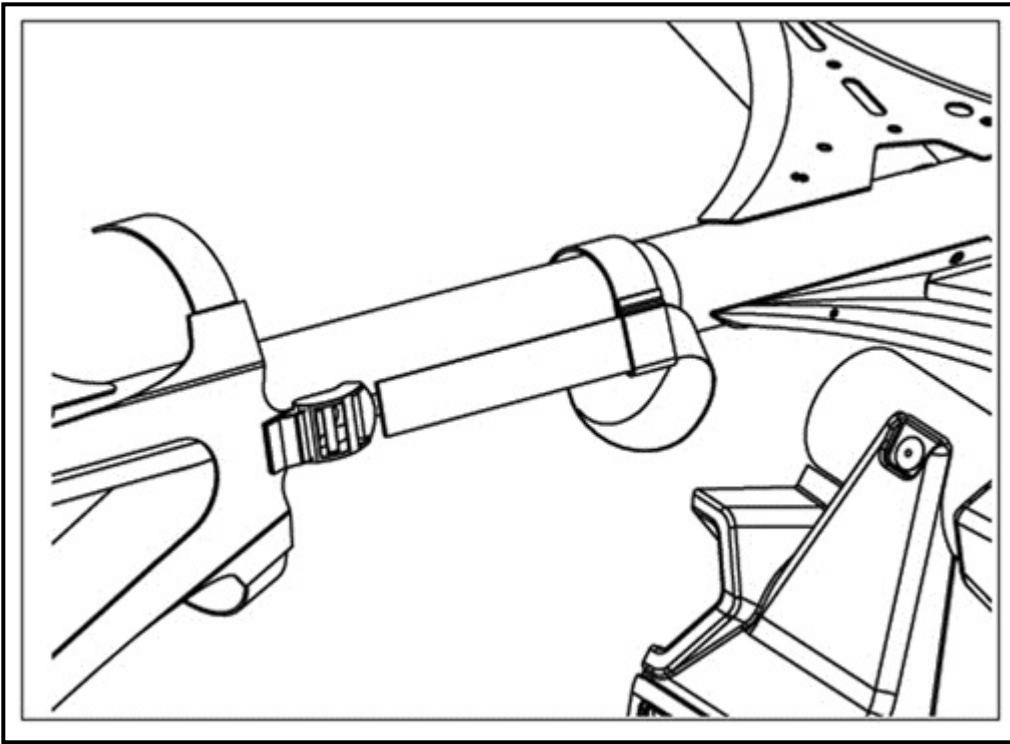

14. Attach 2'x4" Self-adhesive loop [28] to front Top Bracket: Use strap on rear of door skin to locate self-adhesive hook. Peel off adhesive cover and attach to top front bracket. Fold self-adhesive loop under bracket.

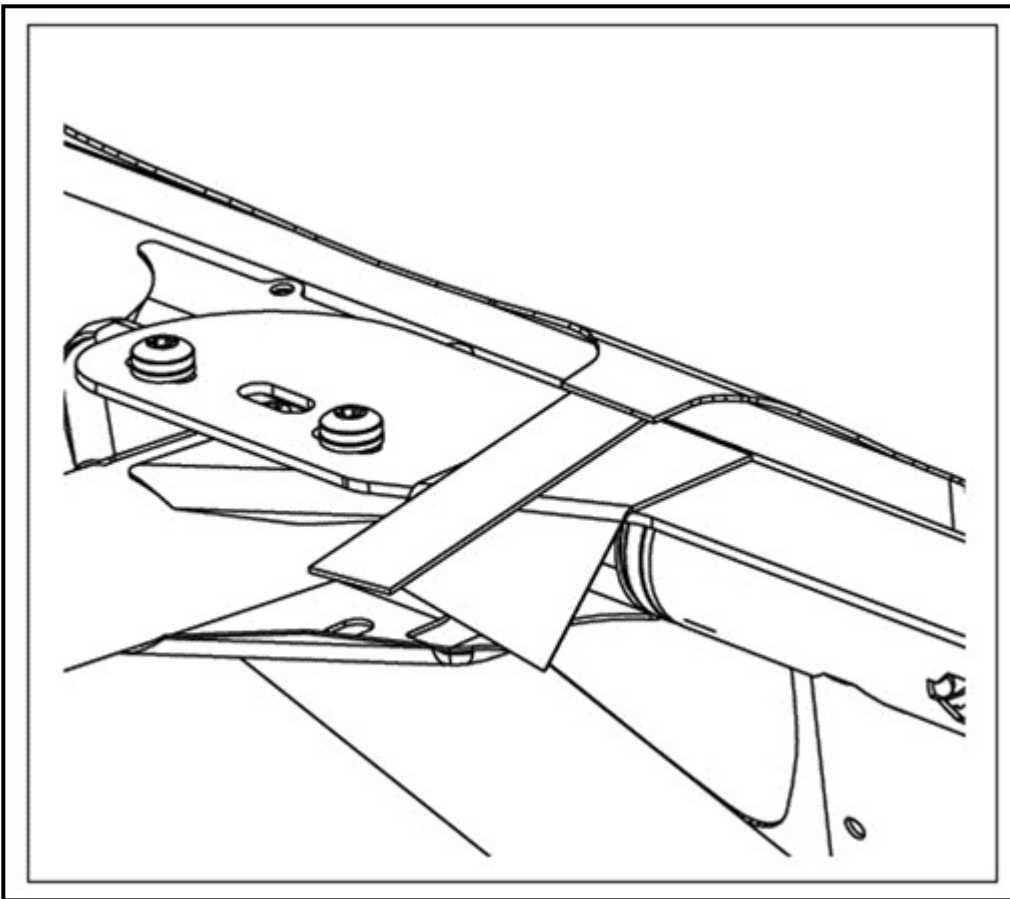

15. Rear door to vehicle: Insert rear door frame bracket under rear door tube. Assemble 1" tube arches [27] with M6 Torx Button head cap screw [25] and M6 washer [23].

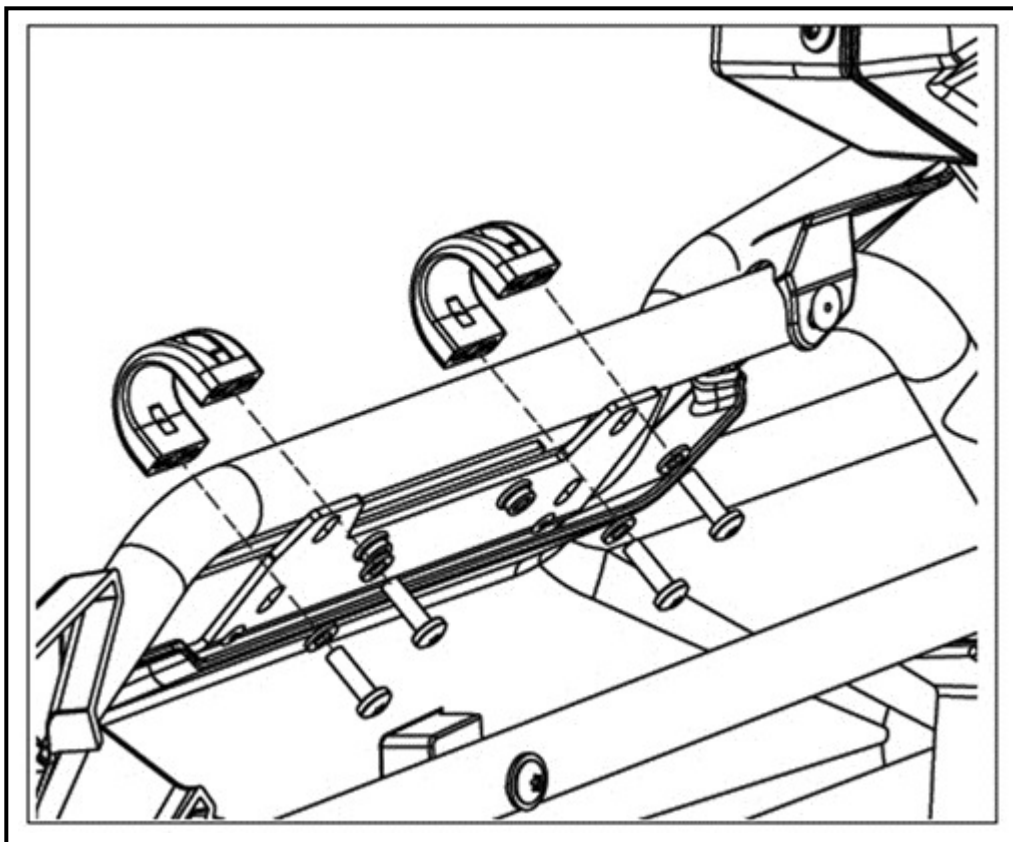

16. Attach hinge to Top rear Bracket: Locate hinge to sit flat on bottom of Top Bracket, use M6 washer [23], M6 Torx button head screw [25] & M6 lock nut [24] to secure to Top Bracket. (hardtop removed for clarity) Repeat for opposite side

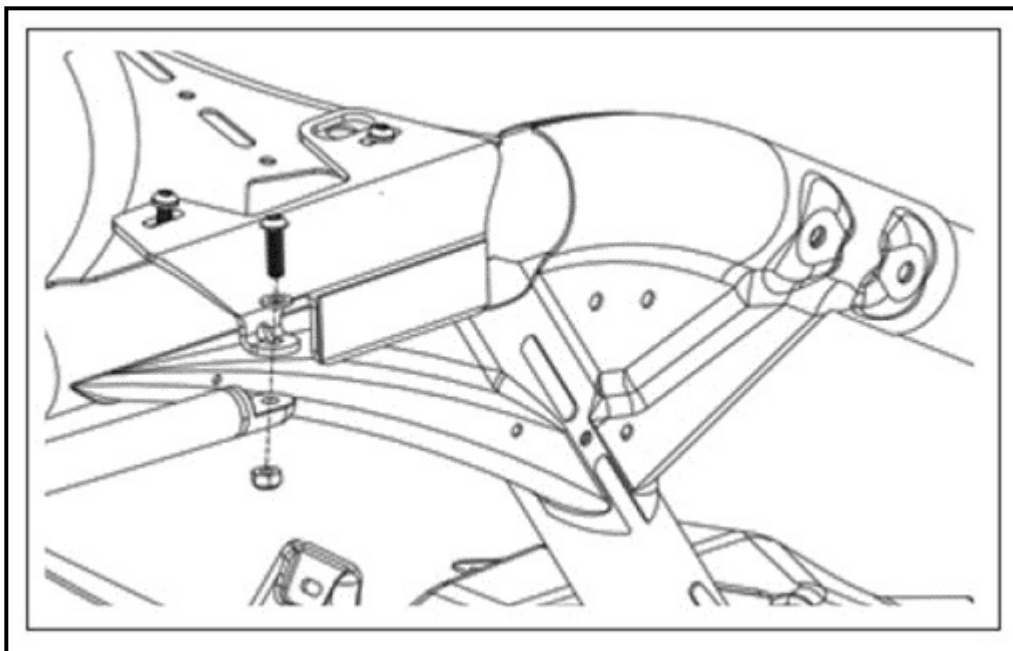

17. Attach hinge to Top rear Bracket: Locate hinge to sit flat on bottom of Top Bracket, use M6 washer [23], M6 Torx button head screw [25] & M6 lock nut [24] to secure to Top Bracket. (hardtop removed for clarity) Repeat for opposite side

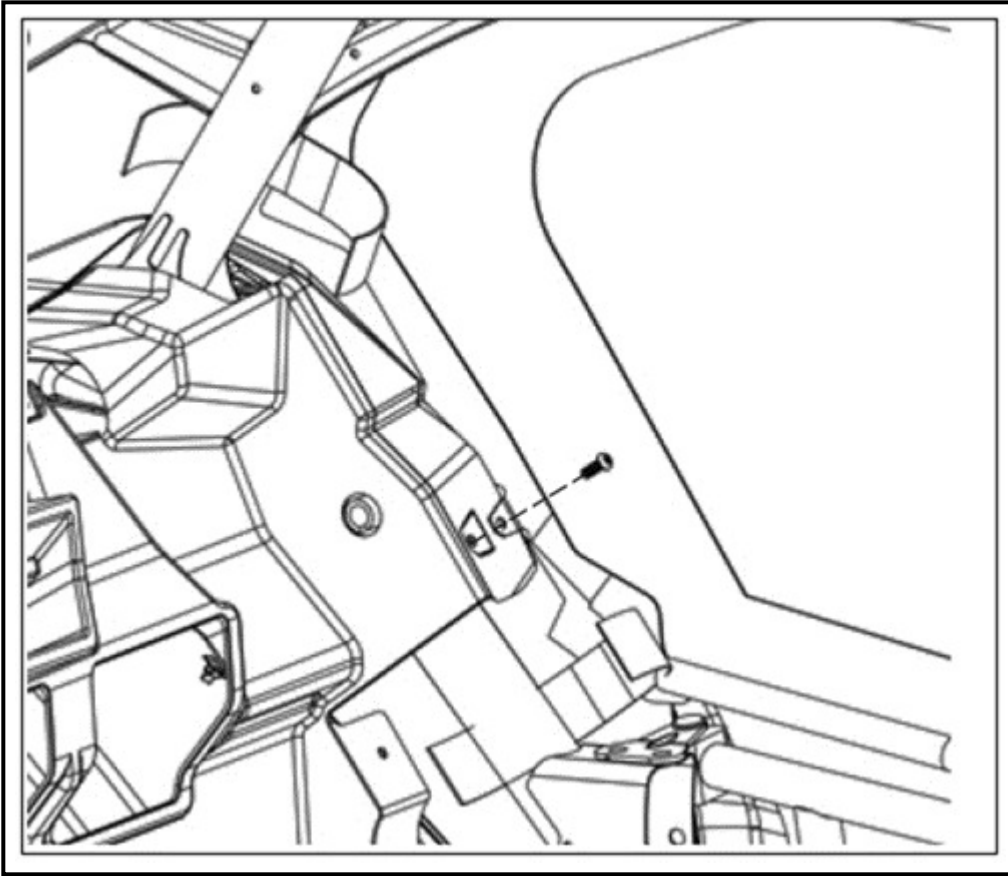

18. Attach bracket cover to bracket: Place cover over bracket. Locate snaps on cover over the snaps on bracket. Push cover until it is secured to bracket.

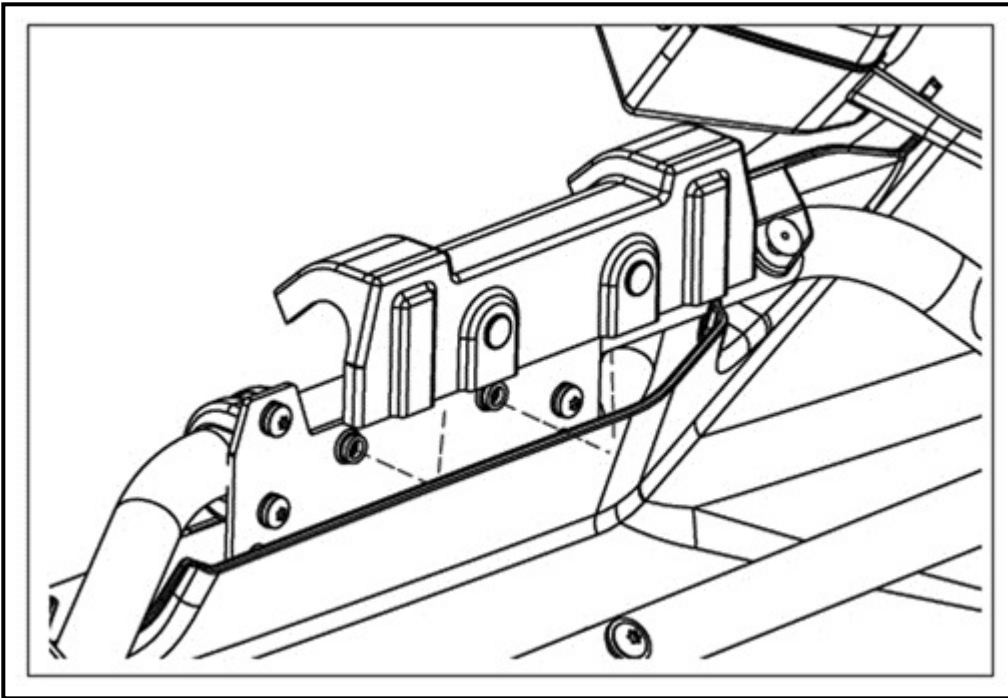

Users with sports roof must cut both sides of their roof according to the following dimensions:

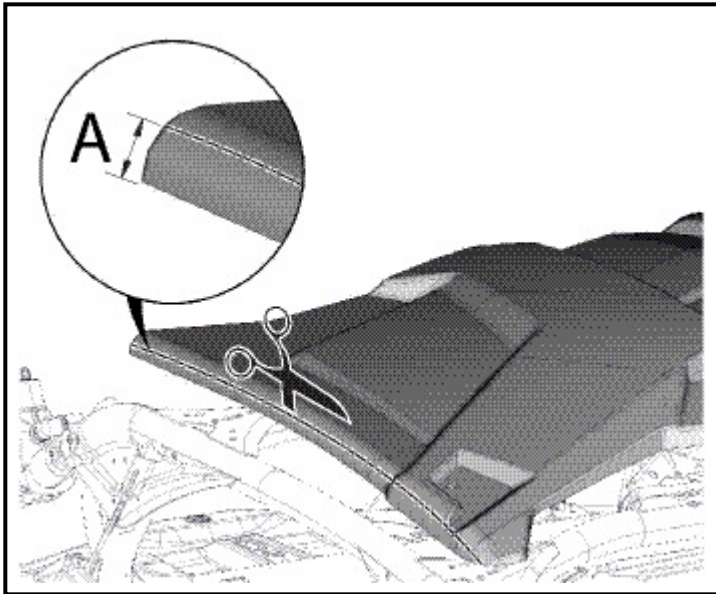

A. Dimension is 16mm from the edge

[Template.pdf](#)