

# SSV KIT - Panoramic Central Mirror

Part number (SKU) : 715003638

Product:	Side-by-side
Project no:	487802155
Instruction Sheet P/N:	487802155
Revision no:	
Revision date:	
Item covered:	Panoramic Central Mirror

The following symbols may be used in this document:

## WARNING

Indicates a hazardous situation which, if not avoided, could result in death or serious injury.

**⚠ CAUTION:** Indicates a hazard situation which, if not avoided, could result in minor or moderate injury.

**NOTICE** Indicates an instruction which, if not followed, could severely damage vehicle components or other property.

## WARNING

- This kit is designed for specific applicable models only (authorized BRP dealers will confirm model(s)). It is not recommended for units other than the one (those) for which it was sold.
- If the installation of the kit requires a template, ensure template is to scale.
- Should removal of a locking device (e.g. lock tabs, self-locking fasteners, etc.) be required when undergoing disassembly/ assembly, always replace with a new one.
- Torque wrench tightening specifications must strictly be adhered to.

**NOTE:** USE TIGHTENING TORQUES IN THE FOLLOWING TABLE IF NOT OTHERWISE SPECIFIED.

	GRADE			
	5.8	8.8	10.9	12.9
M4	1.8 ± 0.2 N•m (16 ± 2 lbf•in)	2.8 ± 0.2 N•m (25 ± 2 lbf•in)	3.8 ± 0.2 N•m (34 ± 2 lbf•in)	4.5 ± 0.5 N•m (40 ± 4 lbf•in)
M5	3.3 ± 0.2 N•m (29 ± 2 lbf•in)	5 ± 0.5 N•m (44 ± 4 lbf•in)	7.8 ± 0.7 N•m (69 ± 6 lbf•in)	9 ± 1 N•m (80 ± 9 lbf•in)
M6	7.5 ± 1 N•m (66 ± 9 lbf•in)	10 ± 2 N•m (89 ± 18 lbf•in)	12.8 ± 2.2 N•m (113 ± 19 lbf•in)	16 ± 2 N•m (142 ± 18 lbf•in)
M8	15.3 ± 1.7 N•m (135 ± 15 lbf•in)	24.5 ± 3.5 N•m (18 ± 3 lbf•ft)	31.5 ± 3.5 N•m (23 ± 3 lbf•ft)	40 ± 5 N•m (30 ± 4 lbf•ft)

M10	29 ± 3 N•m (21 ± 2 lbf•ft)	48 ± 6 N•m (35 ± 4 lbf•ft)	61 ± 9 N•m (45 ± 7 lbf•ft)	73 ± 7 N•m (54 ± 5 lbf•ft)
M12	52 ± 6 N•m (38 ± 4 lbf•ft)	85 ± 10 N•m (63 ± 7 lbf•ft)	105 ± 15 N•m (77 ± 11 lbf•ft)	128 ± 17 N•m (94 ± 13 lbf•ft)
M14	85 ± 10 N•m (63 ± 7 lbf•ft)	135 ± 15 N•m (100 ± 11 lbf•ft)	170 ± 20 N•m (125 ± 15 lbf•ft)	200 ± 25 N•m (148 ± 18 lbf•ft)
M16	126 ± 14 N•m (93 ± 10 lbf•ft)	205 ± 25 N•m (151 ± 18 lbf•ft)	255 ± 30 N•m (188 ± 22 lbf•ft)	305 ± 35 N•m (225 ± 26 lbf•ft)
M18	170 ± 20 N•m (125 ± 15 lbf•ft)	273 ± 32 N•m (201 ± 24 lbf•ft)	330 ± 25 N•m (243 ± 18 lbf•ft)	413 ± 47 N•m (305 ± 35 lbf•ft)

The illustrations in this document show typical construction of the different assemblies and may not reproduce the full detail or exact shape of the parts; however, they represent parts that have the same or similar function.

Installation time is approximately 0.2 hour

## PARTS TO BE INSTALLED

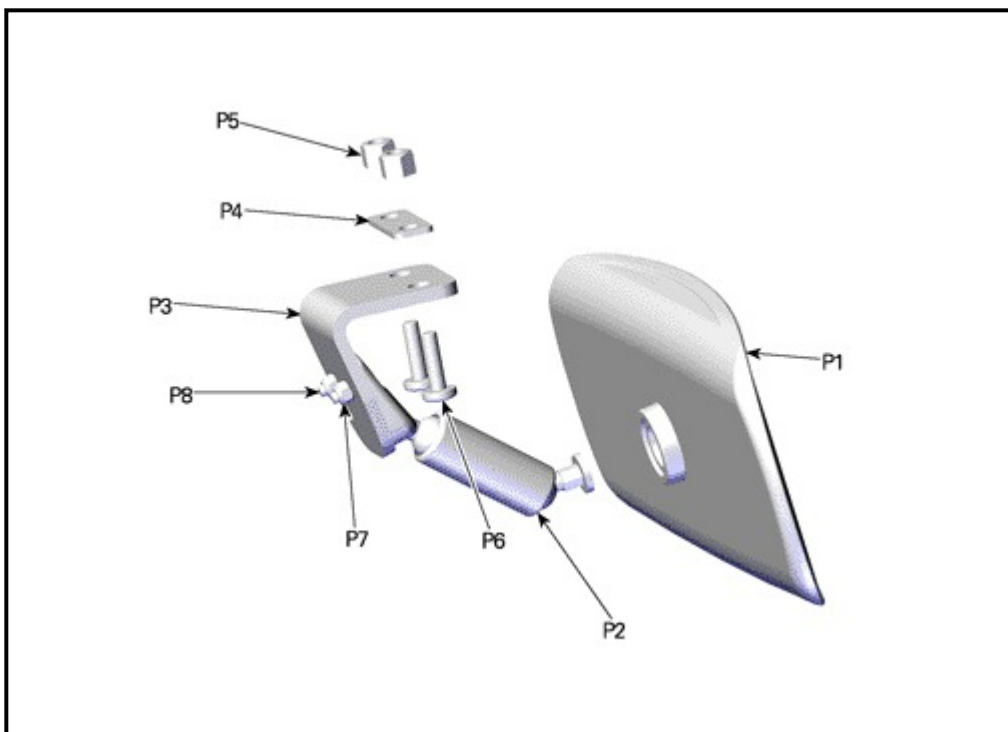

**NOTE:** [P4] isn't a part of this assembly.

ITEM	DESCRIPTION	part number	QTY
P1	Mirror	(not available separately)	1
P2	Mirror support	(not available separately)	1
P3	Bended plate	(not available separately)	1
P4	Plate	(not available separately)	1

P5	M6 Elastic flanged nut	233261494	2
P6	M6 X 20 Torx screw	250000712	2
P7	M4 Elastic stop nut	232541484	2
P8	M4 X 16 Torx screw	250000797	2

# INSTRUCTIONS

## Mirror Preparation

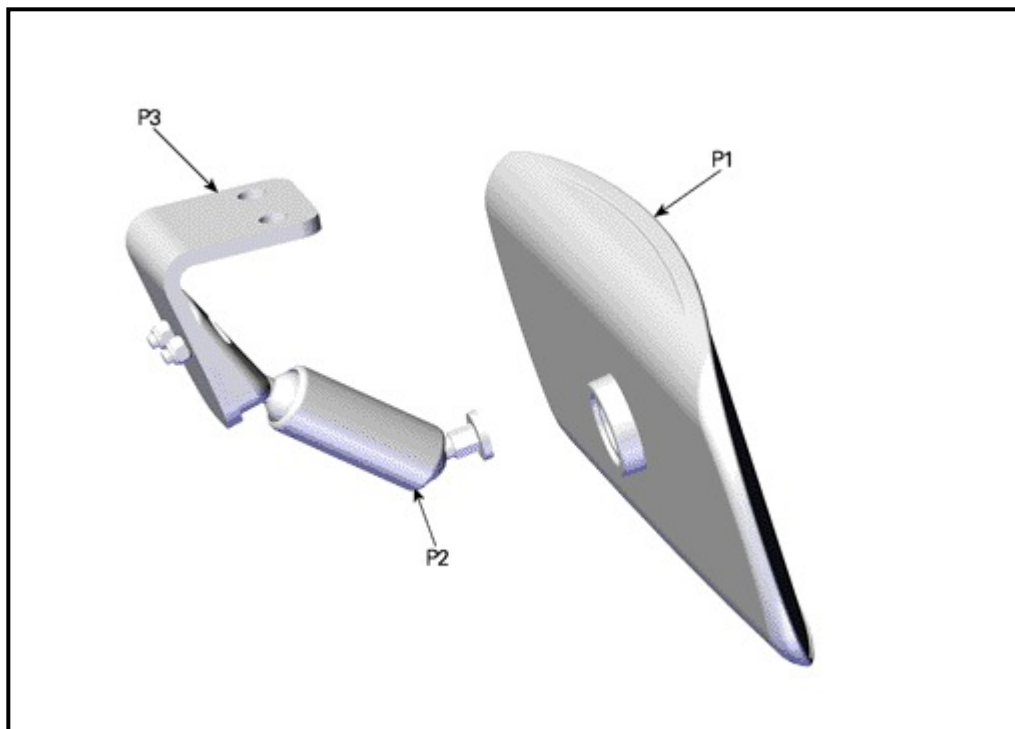

**NOTE:** Apply LOCTITE 243 (BLUE) (P/N 293 800 060) on thread of [P2].

### WARNING

Hand tighten [P1]. Do not torque.

## Mirror Installation

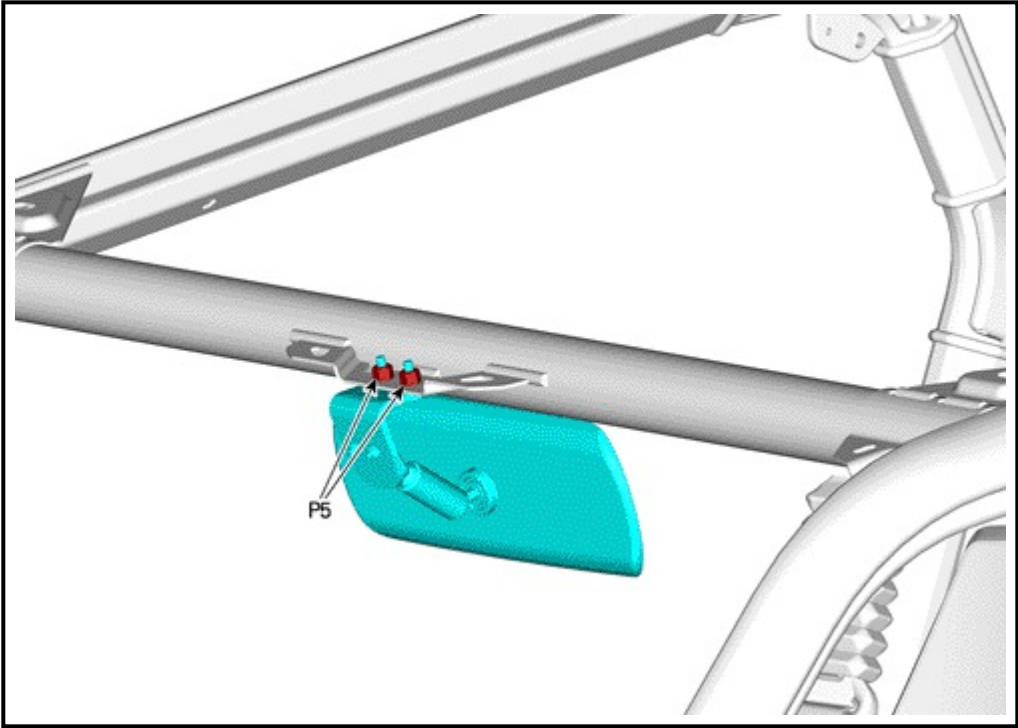

Secure the mirror using M6 X 20 Torx screw [P6] and M6 nut [P5] onto the vehicle frame.

Tightening Torque	
M6 nut [P5]	4 ± 1 N•m (35 ± 9 lbf•in)

Mirror Preparation - With speaker

**NOTE:** This procedure applies when using the speaker support kit (P/N 715004745).

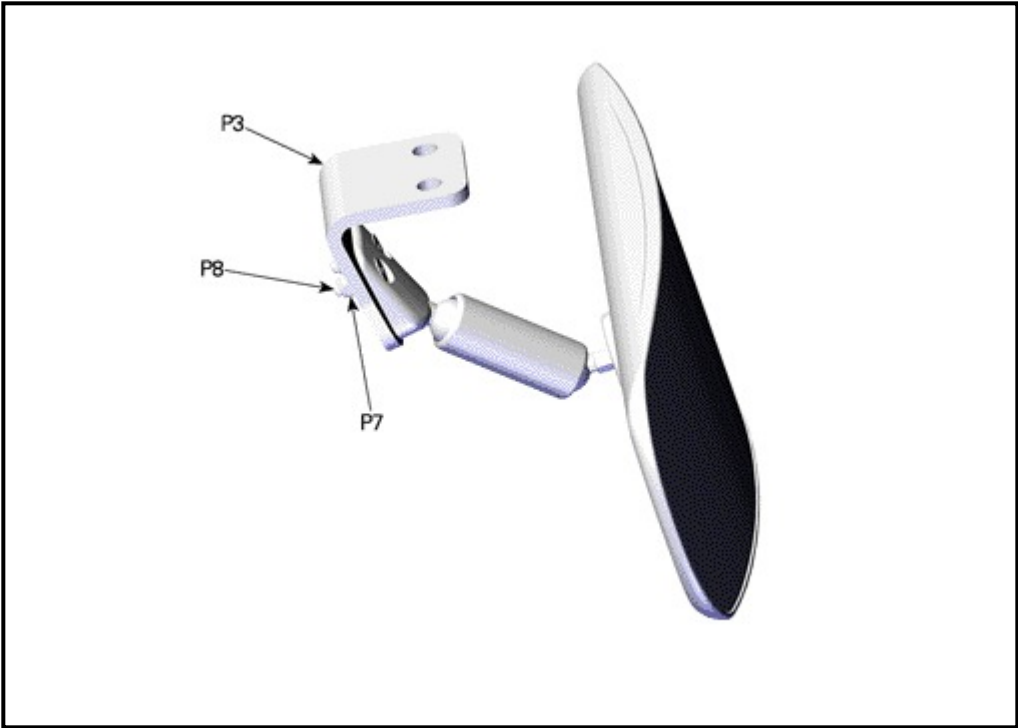

Unscrew the nuts [P7] and the Torx screws[P8] to remove [P3].

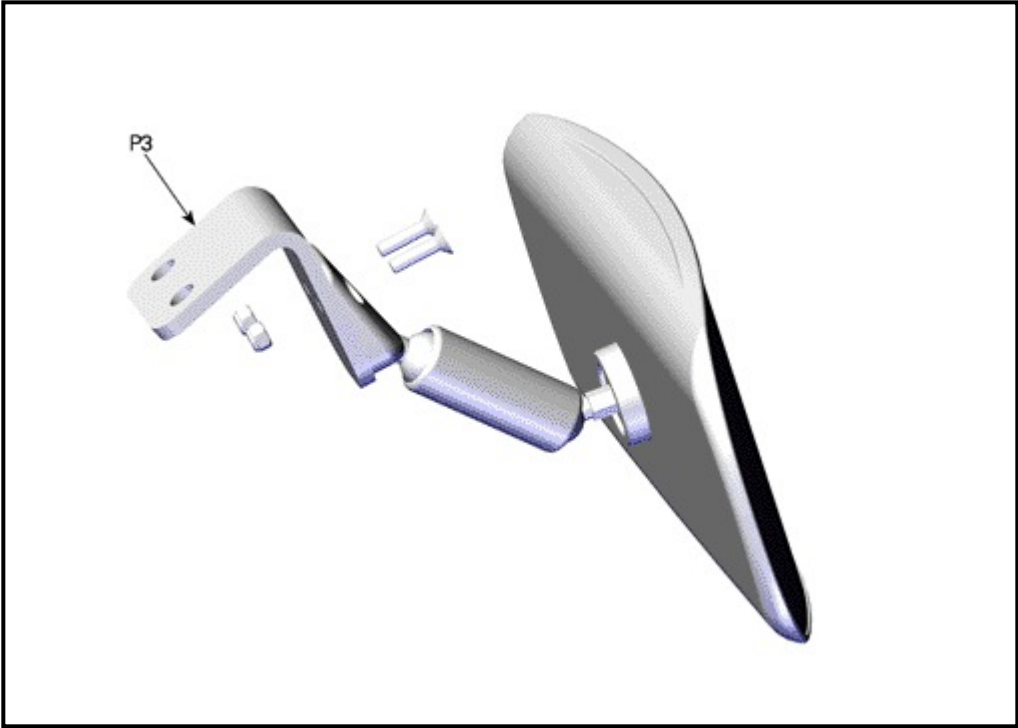

Turn [P3] around.

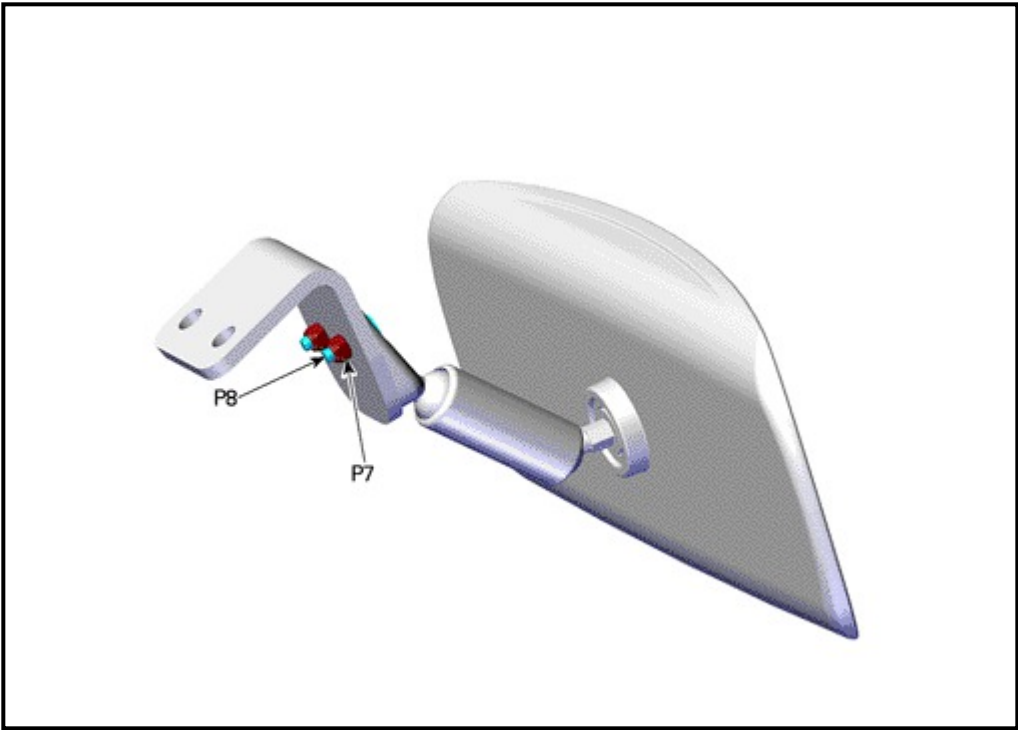

Tighten the assembly by screwing the nuts [P7] and the Torx screws [P8] together.

Tightening Torque	
M4 elastic stop nuts	3.4 ± 0.4 N•m (30 ± 4 lbf•in)

Mirror installation - With speaker

**NOTE:** The mirror must be mounted on the speaker support kit (P/N 715004745) before being installed in vehicle.

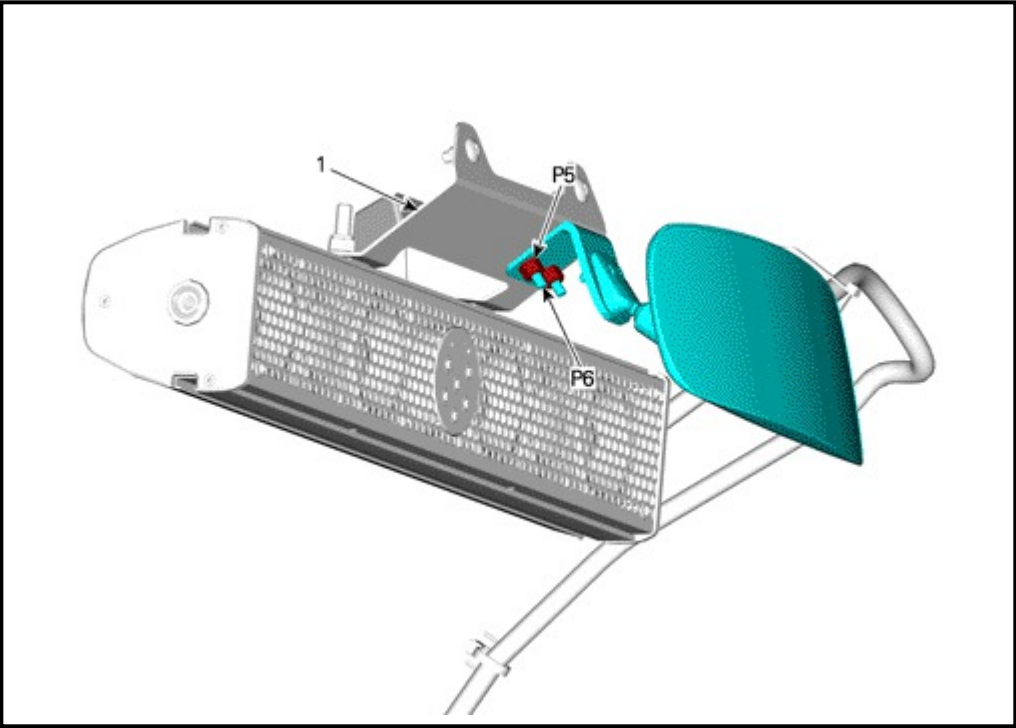

1. Speaker support kit (P/N 715004745)

Secure the mirror on the speaker support kit (P/N 715004745) by screwing the nuts [P5] and the Torx screws [P6] together.

Tightening Torque	
M6 elastic flanged nuts	24.5 ± 3.5 N•m (18 ± 3 lbf•ft)